

Fireguard HF240 Fire Curtain BS EN 16034

Technical Specifications



<https://www.hag.co.uk>
Advice Line 0800 072 3444

Fireguard HF240 Fire Curtain BS EN 16034

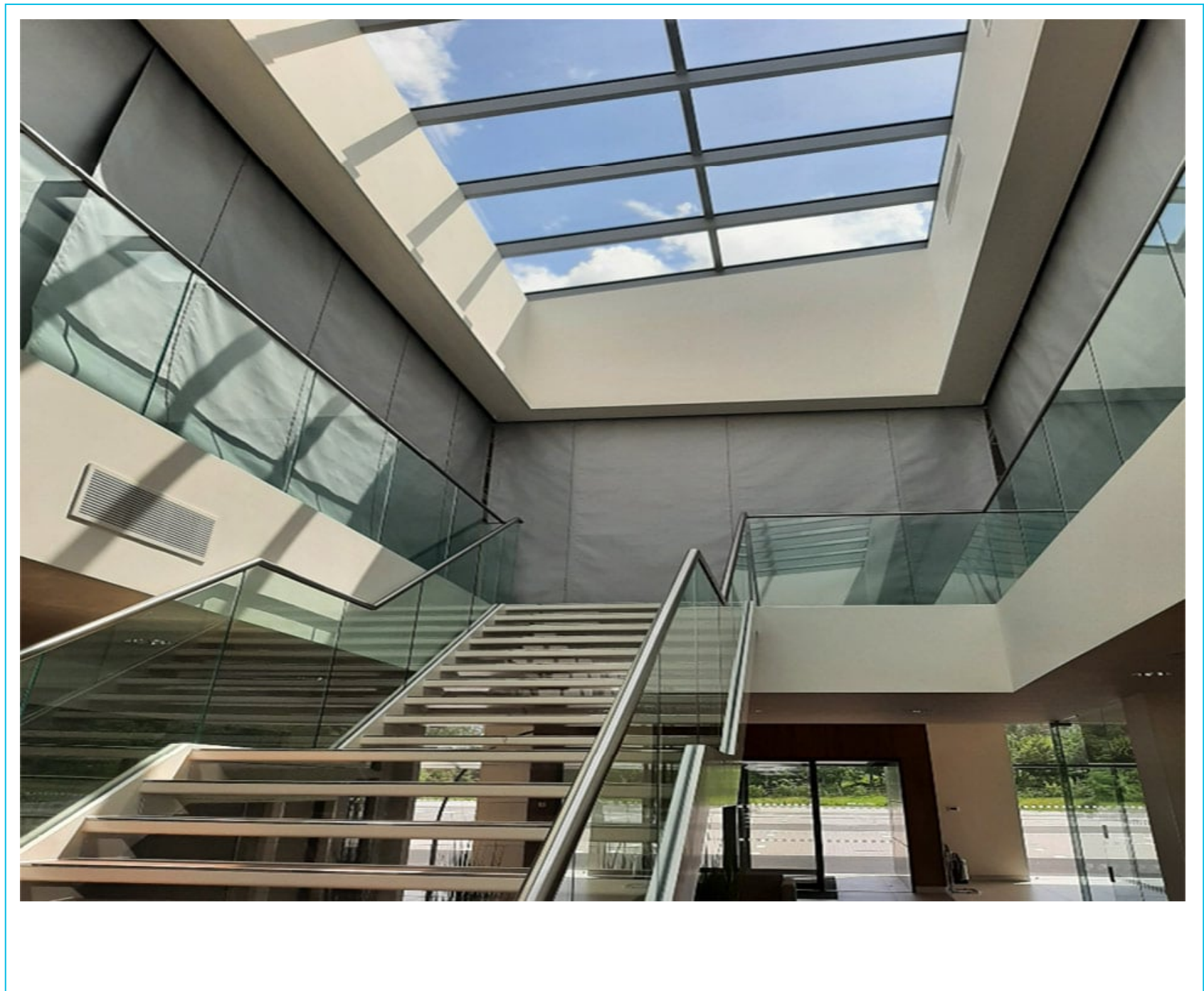

The Fireguard HF240 Fire Curtain is tested & certified to BS EN 16034. This is a premium fire resisting curtain giving up to 240 minute fire protection with the added benefit of up to 60 minutes irradiance shield dependant on size. This adaptable fire curtain can be installed in suspended or solid ceilings. Unlimited widths can be obtained by overlapping curtains. CERTIFIRE approved.

Product Compliance

- Tested & certified to BS EN 16034
- Fire Integrity (E) up to 240 minutes
- Radiation Performance (W) up to 60minutes
- Self-Closing
- Tested and compliant to BS EN 1634
- Full CE Compliance (conformity certificates on request)
- CERTIFIRE Certified

Components Included

Components included as standard: Curtain, Guides, Bottom Rail, Box, Battery Backup, Control Unit, Motor.
Standard powder coat finishes.

Additional specification levels and optimisable components available on request.

Arrangement

Fireguard HF240 Fire Curtain BS EN 16034

The Fireguard HF240 Fire Curtain is flexible in its installation. It can be Face or Reveal Fix to Steel or Masonry. When application requires this fire protection system to be unseen the HF240 can be installed in suspended or solid ceilings.

Curtain Material

The curtain is manufactured from a Woven Fibreglass and Stainless Steel Fabric with a coating of Intumescent Silicone.

Metal studs are sewn into the side of the curtain to ensure its correct position in the guide frames whilst in operation.

Guide Rails

This Fire Curtain has two galvanised steel side guide rails of 100 mm x 50 mm.

Head Plates

Two galvanised steel head plates hold the shaft with the curtain, sizing dependent upon the height of the application.

Head Box

The Fire Curtain assembly comprises of a box housing at high level in which sits the shaft, motor and wrapped Curtain. The box is attached to channel section guides at each end.

Bottom Rail

A galvanised steel 'T' bottom rail provides the weight for the curtain to self-close.

Operation

The system is held in the open position by a Single Phase Electric 24v DC Motor. When a fire is detected or power is lost the motor will disengage and allow the Gravity Failsafe to activate.

Controls

The Fireguard HF240 Fire Curtain system is supplied with gravity failsafe control panel with in-built lead-acid battery support.

Control Options

Dependant on the site fire protection requirements, various options are available to ensure compliance:

- Audio/visual warning devices
- Emergency retract switches
- Split drop & delayed drop programmes
- Beam sensors

Finish

Head box, guides and bottom rail are galvanised at source and can be powder coated as required to any standard RAL or BS4800 colour.

Fire curtains are naturally silver grey or charcoal finish, dependent on specification.

Optional Extras

Other optional extras include:

- Split drop
- Delay on alarm
- Beam sensor
- Emergency retract switches
- Smoke seals
- Visual alert system

Installation

These fire resisting curtains are suitable only for internal applications.

HAG provides full installation, repair and maintenance for the Fireguard HF240 Fire Curtain anywhere in the UK.

Maintenance

Regular maintenance is required for all safety products by Law. Competitive maintenance contracts are available on request.

Fireguard HF240 Fire Curtain BS EN 16034

Product specification may change and it is advisable to consult with HAG technical advisors before specifying or ordering. HAG operates a policy of continuous improvement.

