

## Threshold Options

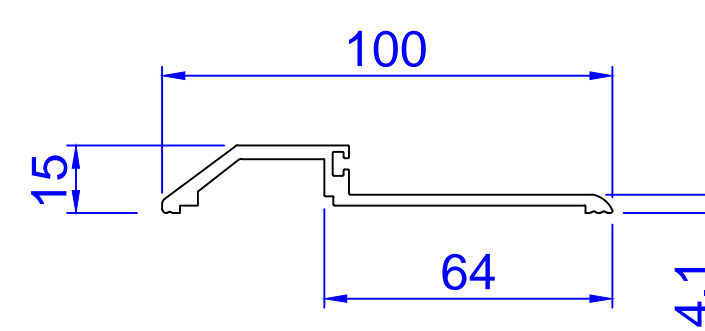

Zero 564  
15mm ALUMINIUM

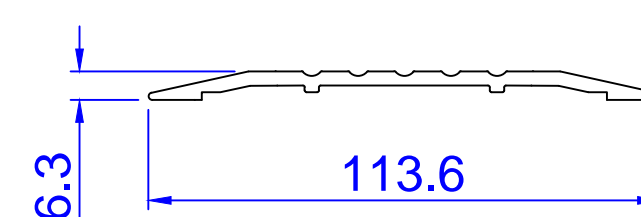

6mm DRIVABLE

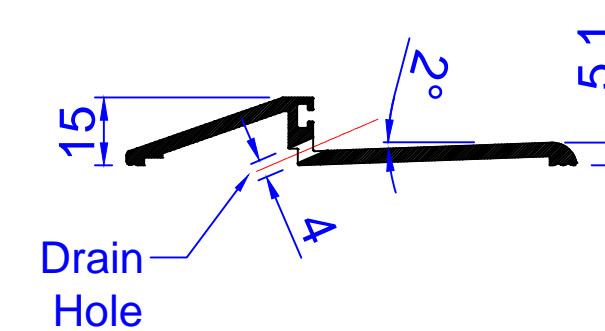

15mm ALUMINIUM  
(INWARD OPENING)

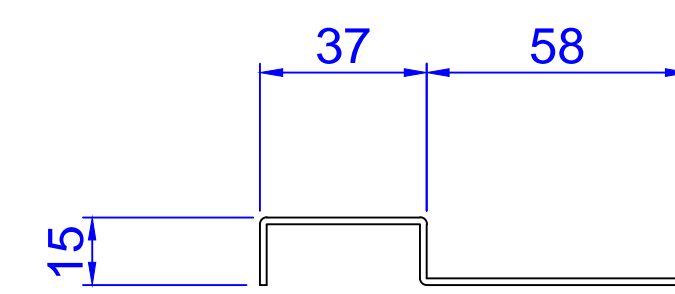

Standard  
15mm STEEL

Scale: 1:5 @ A4

## Frame Options

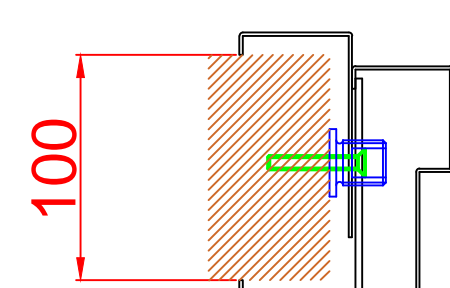

Type A

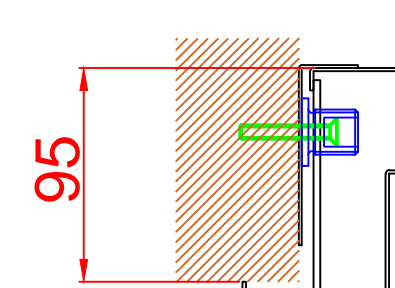

Type B

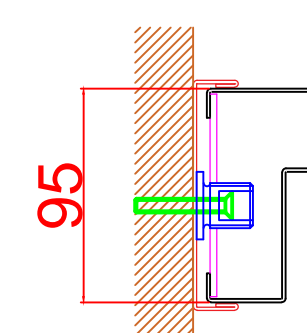

Type C

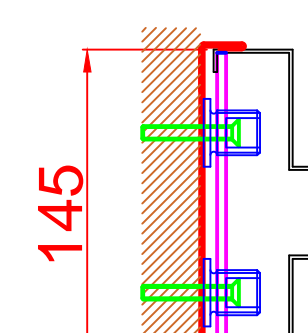

Type D

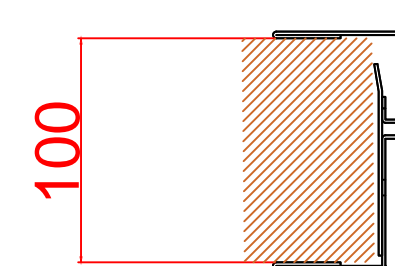

Type E

Scale: 1:10 @ A4

## Disclaimer

HAG Operates a policy of continuous improvements, product specification may change, and it is advisable to consult with HAG technical advisors before specifying or ordering.

## NOTE:

Do Not Scale From This Drawing

**Product:** AD05 Armourdoor

**Ironmongery:** (TBA)  
(Drawn With) Stainless Steel Hinges  
C/W Dog Bolts, Sashlock, Levers,  
Double Euro Cylinder, & Door Closer

**Operation:** Manual

**Infill:** N/A

**Threshold:** Std (See Available Choices)

**Frame:** Type C (See Available Choices)

**Fixing:** Within the Reveal

**Finish:** Primer or PPC (PPC Colour  
Options, Contact Office To Discuss)



Drawn By: HAG

Date: 20/03/17

Std Drawing For AD05 Single Steel Doorset