

# NOTE:

Do Not Scale From This Drawing

**Product:** FD01 Fireguard

**Ironmongery:** (TBA)  
(Drawn With) 4.5mm Gap Std Hinge  
SSS Dog Bolt, Multipoint Sash Lock  
C/W Lever Set, Euro Double Cylinder  
Nickel Finish, Pair Security  
Escutcheons, Surface Mounted Door  
Closer, 75mm DIA "FIRE DOOR KEEP  
SHUT" Sign

**Operation:** Manual

**Infill:** 3.1WM2/K Or 1.6Wm2K Options

**Threshold:** Std (See Available Choices)

**Frame:** Type C (See Available Choices)

**Fixing:** Within the Reveal

**Finish:** PPC (PPC Colour Options,  
Contact Office To Discuss)

**Fire Ratings Available:** 30, 60, 120, or  
240 Minutes

## Threshold Options

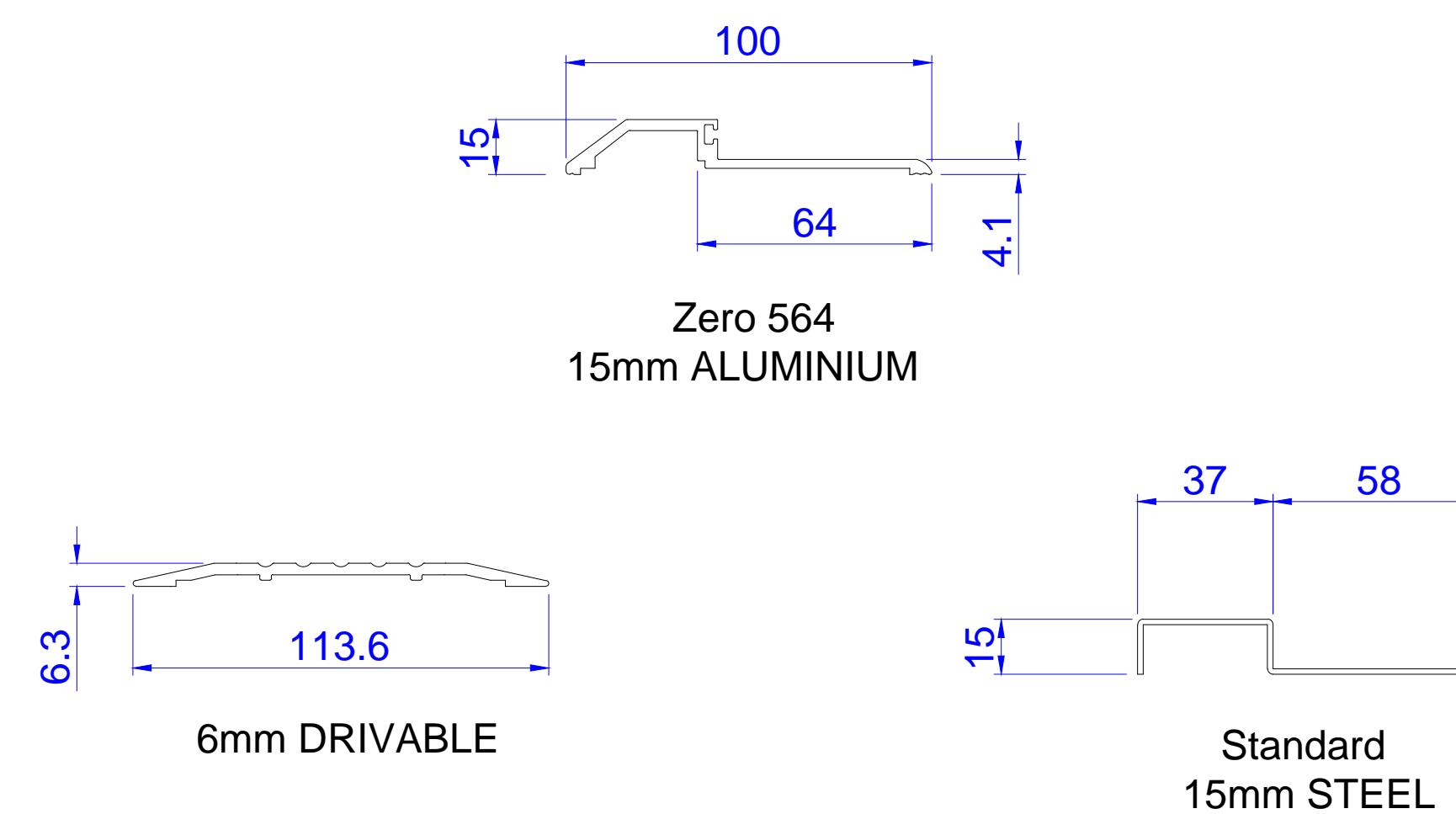

Scale: 1:5 @ A4

## Frame Options

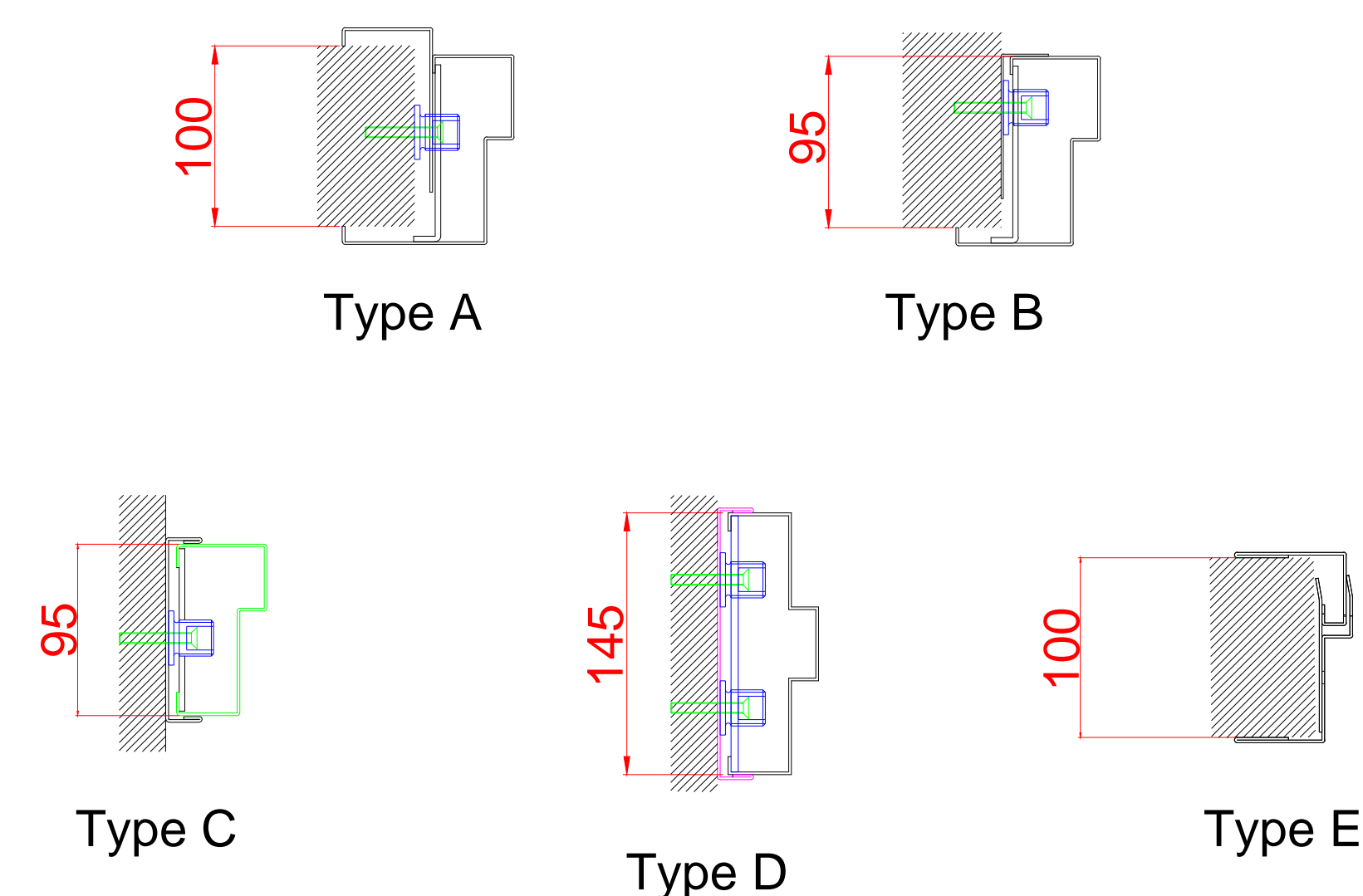

Scale: 1:10 @ A4

## Disclamier

HAG Operates a policy of continuous improvements, product specification may change, and it is advisable to consult with HAG technical advisors before specifying or ordering.

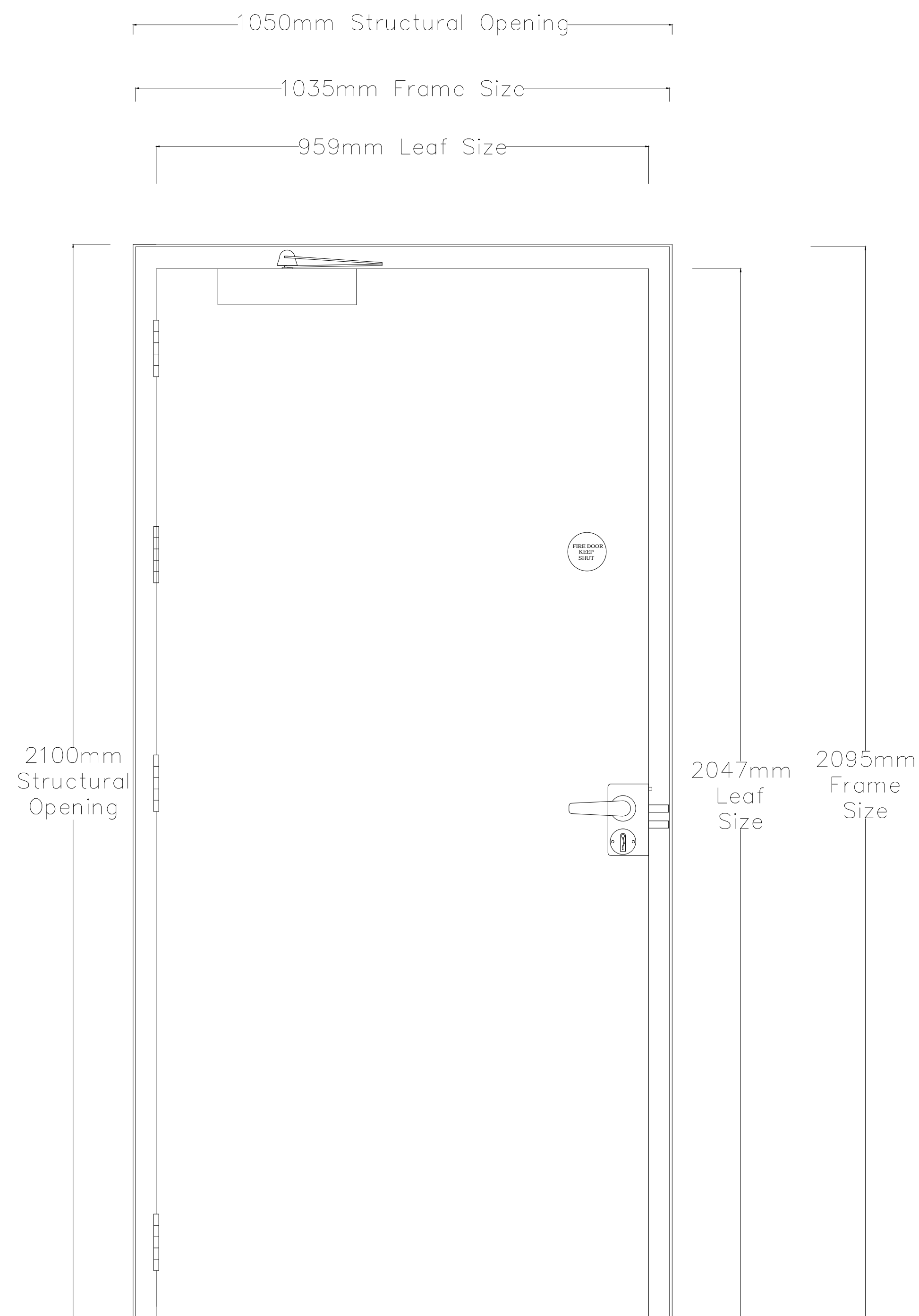

Drawn By: HAG

Date: 10/10/23

Std Drawing For FD01 Single Steel Doorset

